

Cellular Monitoring

FWT 3G/4G

Stay in touch with your EliteControl System

EliteControl 
www.aap.co.nz

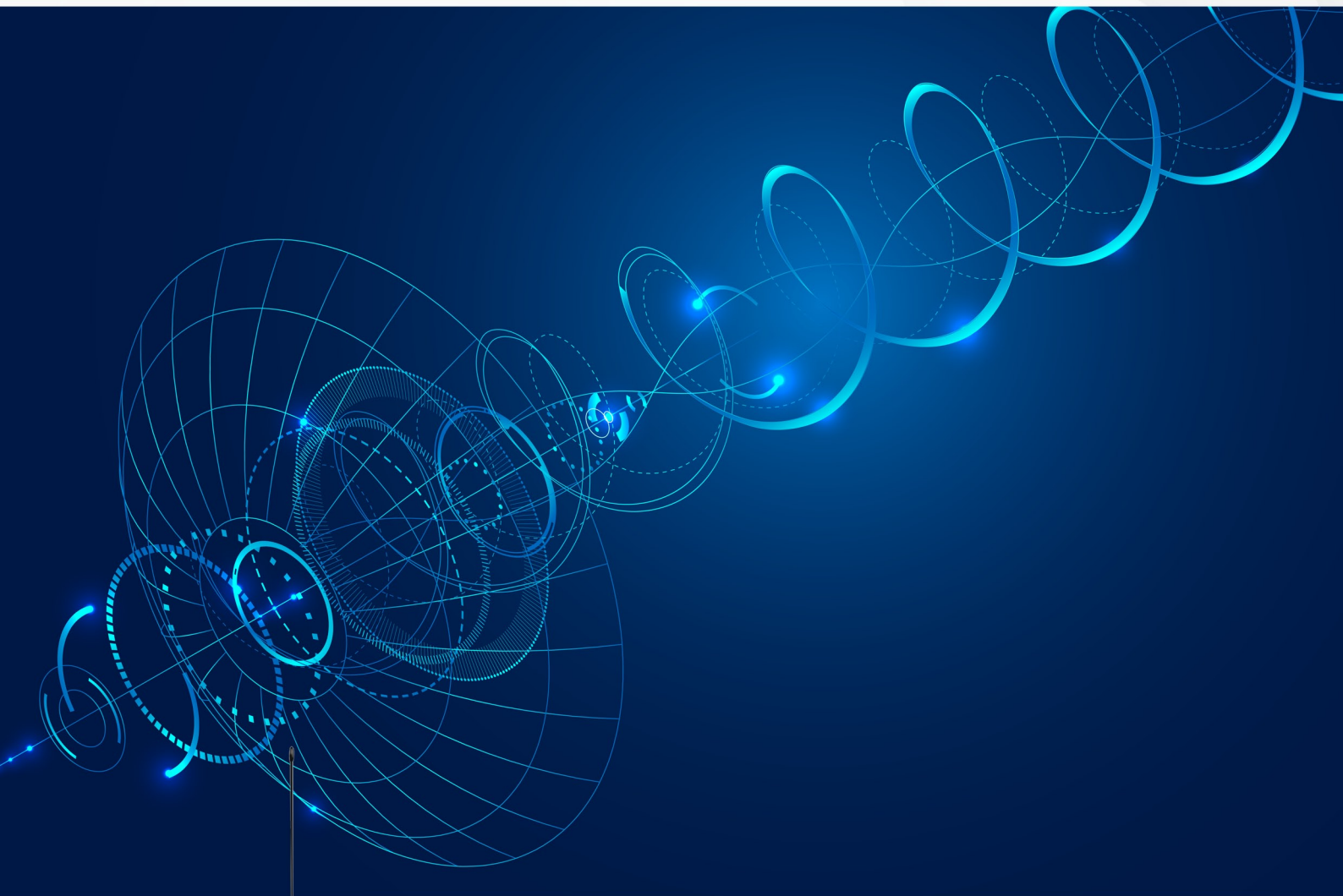

- 2G, 3G & 4G Cellular Monitoring Device
- Compatible with EliteControl Systems
- Simple Installation
- Spark, Vodafone or 2Degrees
- Includes High Gain Antenna
- Possible DTMF Control
- Receive a call upon Alarm Activation

Monitoring with **eTROSS**

www.aap.co.nz

FWT 3G/4G Specifications

Cellular Network	2G, 3G & 4G
Cellular Module	Quectel EC25-AU
4G Cellular Bands	B1/B2/B3/B4/B5/B7/B8/B28/B40
3G Cellular Bands	B1/B2/B5/B8
2G Cellular Bands	GSM850/900/1800/1900Mhz
Dimensions	170mm x 118mm x 30mm
Power Supply	5V/DC, 300mA Max. (note: plugpack included)
Phone Outlets	2 x RJ11
Antenna connector	SMA Female
Requires ESL-2 DIAL POD	✓

Key Functions

The FWT 3G/4G is a standard PSTN landline to cellular converter for analogue phone calls. Alarm monitoring signals can be sent via the cellular network and you can receive incoming calls to analogue telephones/alarm panels

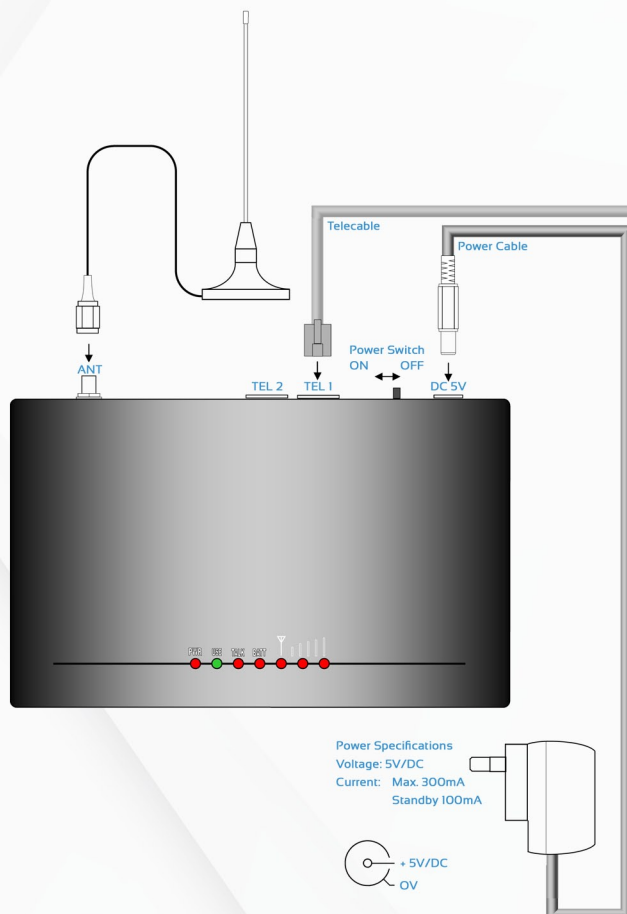

Wiring Diagram

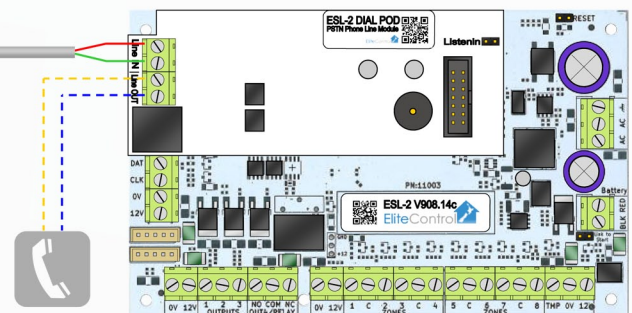

Telephone

The line out terminals can still have standard PSTN touch tone telephones connected into it.

Warning: any calls made using this telephone will incur usual cellphone calling rates, charged to the SIM card in the FWT 3G/4G